

1

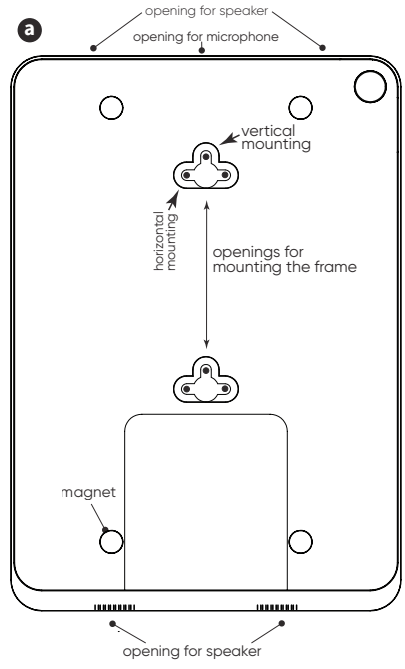

b

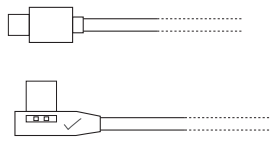

c



2

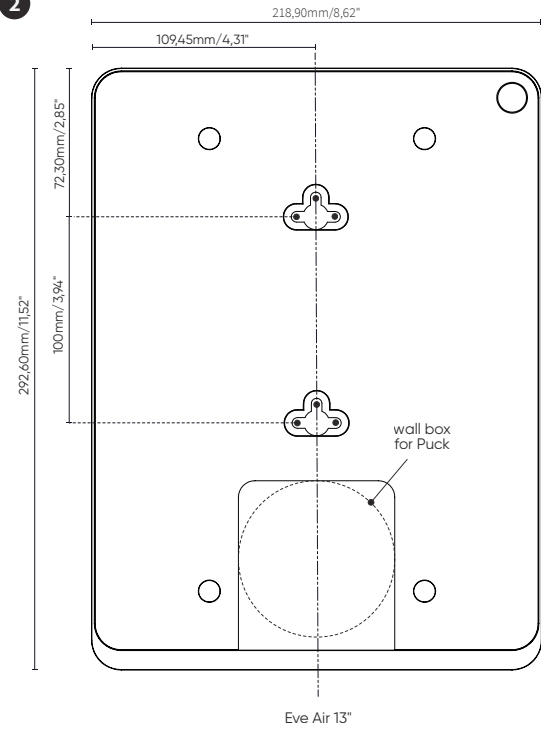

3

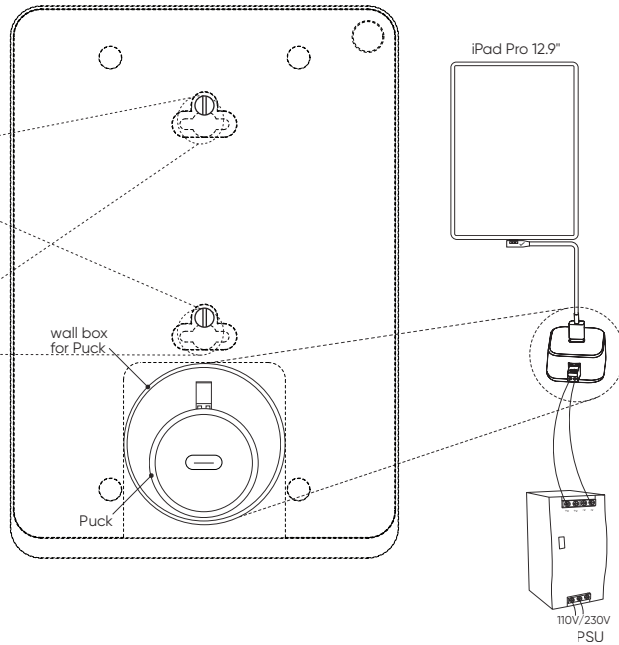

4

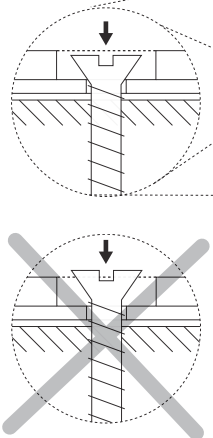

5

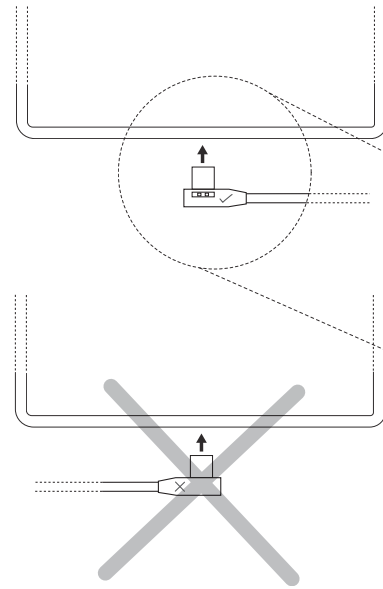

6

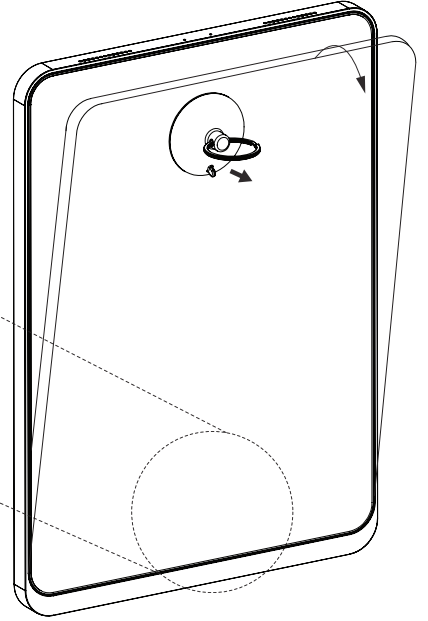

1 Identification of the parts

- a Eve Air 13" frame (*product number: 0657-xx*)
- b Custom angled USB-C to USB-C cable
- c Suction cup

2 Positioning of the wall box (*not included*)

A wall box should be foreseen to install the iPad power supply. The Puck (*not included*) is a USB power supply which fits into a 1-gang wall box and uses the USB-C cable, supplied with the iPad.

The wall box should be installed according to the dimensions on the drawing (2).

3 Puck USB-C power supply (*not included - 0610-04*)

Install the Puck in the wall box following the instructions of the Puck manual. Connect the USB-C cable, supplied with the Eve frame to the Puck.

The maximum output power of the puck is 20W.

4 Installing the frame

Please use the correct openings of the Eve frame and ensure the screws are positioned so that they cannot damage the iPad.

5 Mounting the iPad

1. Plug the power connector into the iPad.
Make sure the USB-C cable is connected in proper orientation. Inserting the cable in the wrong direction can damage the iPad once you mount it in the Eve frame.
2. Place the iPad in the opening of the frame so that it is being held by the magnets.
Make sure that the power cable is not squeezed between the iPad and the frame.

6 Removing the iPad

1. Place the suction cup on the iPad screen and push lightly to create suction.
2. Gently pull the iPad making sure it cannot fall.
3. Disconnect the power connector.

Dimensions Eve Air 13"

Frame: 292,6mm/11.52" x 218,90mm/8.62" x 10mm/0.39"

Eve Air 13" is compatible with iPad Pro 12.9" (3rd, 4th, 5th and 6th gen)

Made in Belgium

Basalte is a registered trademark of Basalte bv.
Eve is a registered trademark of Basalte bv.
Eve mini, Eve 9.7", Eve Pro 9.7" -11" & -12.9" and Eve touch are registered designs of Basalte bv.
iPad mini, iPad Air, iPad, iPad Pro and iPod touch are registered trademarks of Apple Inc.

Basalte bv

Fraterstraat 37b
9820 Merelbeke
Belgium

tel +32 9 385 78 38

info@basalte.be
www.basalte.be

eve | air 13"